

Chicago, IL Data Center ORD-02

501 Northwest Avenue
Northlake, IL 60164
+1.833.425.4463

Overview

Aligned's ORD-02 data center is ideally located in Northlake, IL, just outside of downtown Chicago. Aligned's Chicagoland hyperscale campus covers 18.5 acres of land and is strategically located at the convergence of 12+ metro, longhaul and international networks. At full build, Aligned's Chicago campus covers 520,000 sq. ft. and offers ~72 MW of critical load. Aligned's Chicago campus also provides convenient access to adjacent interstates and rail lines, city water pumping station, as well as O'Hare International Airport. Chicago's central location, attractive sales tax incentives, ample connectivity, and expansive talent pool make it an attractive location for hyperscale companies and cloud service providers, multinational enterprises, technology corporations, and other business entities to locate their mission-critical infrastructure.

18.5



BUILDING ACRES

228,768



GROSS SQUARE FEET

36 MW



MEGAWATTS

Building Specifications

LOCATION

- 18 mi. to Chicago, Illinois' largest city, with a low probability of natural disasters
- Close proximity to two international airports:
 - O'Hare International: 7.5 mi
 - Midway International: 24.9 mi

POWER

- Uninterruptable Power Supply
- Dual substation service, 170 MW total capacity
- Low utility cost: \$0.057/kWh (subject to change)

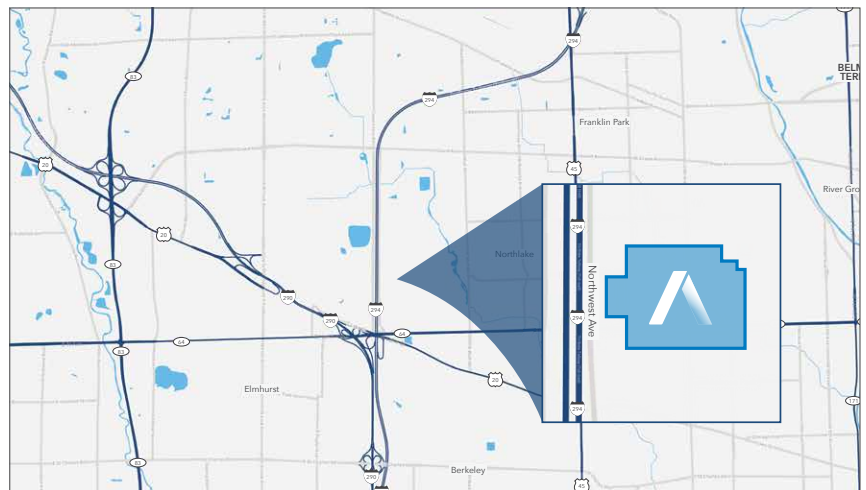

ORD-02 DATA HALL LAYOUTS

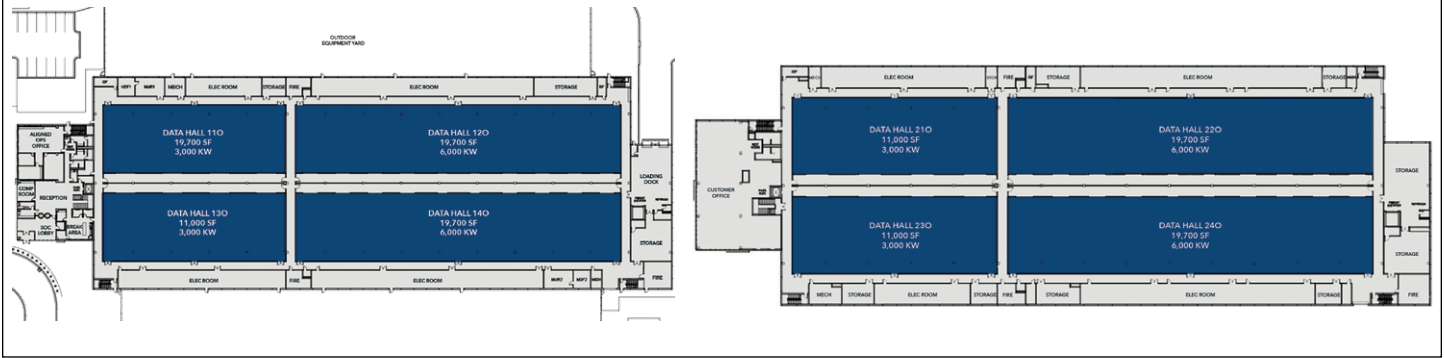

Building Specifications

FIRE PROTECTION

- Separately zoned data halls
- Very Early Smoke Detection Apparatus (VESDA)
- Dual interlock pre-action system

SUSTAINABILITY

- Waterless data center
- 100% renewable energy available
- 100% sustainably funded company
- Carbon reporting & reduction (including embodied carbon tracking)
- Industry-leading PUE, WUE and CUE
- Green Globes Certification (ORD-01)
- EPA Green Power Partner

SECURITY

- Steel security fencing with laser intrusion detection
- Multi-layer security design
- Card reader access
- Motorized gates
- Event-driven IP video surveillance and visual light-based alerts
- 24x7x365 on-site security guards
- Multiple checkpoints, mantraps, dual authentication
- Event-driven IP video surveillance

COMPLIANCE

- (SOC) 2 Type 2 and SOC 1 Type 2, PCI DSS, HIPAA, HITECH, NIST 800-53, ISO 27001:2013

COOLING

- Our Delta Cube cooling absorbs heat at its source—supporting variable power densities and allowing vertical and horizontal scale—without stranding capacity
- Configurable to customer needs (i.e. N, N+1, 2N)
- Removes heat directly at the source—supporting standard and high power densities and allowing you to scale vertically and horizontally—without stranding capacity

POLICY

- Business-friendly and economically stable location
- Exemptions from sales and use tax for qualifying data centers available via Illinois' Department of Commerce and Economic Opportunity (DCEO) exemption certificate

NETWORK CARRIERS

- | | | |
|----------|----------------|----------------|
| ■ AT&T | ■ Zayo | ■ Crown Castle |
| ■ Cogent | ■ PacketFabric | ■ Comcast |



CONTACT ALIGNED TO LEARN MORE

sales@aligneddc.com
+1.833.425.4463

Corporate Headquarters

2800 Summit Avenue
Plano, Texas 75074

Aligned is an infrastructure technology company that offers adaptable colocation and build-to-scale solutions to cloud, enterprise, and managed service providers. Our intelligent infrastructure allows densification and vertical growth within the same footprint, enabling customers to scale up without disruption, all while maintaining industry-leading Power Usage Effectiveness (PUE).

By reducing the energy, water and space needed to operate, our data center solutions, combined with our patented cooling technology, offer businesses a competitive advantage by improving sustainability, reliability and their bottom line.

For more information, visit www.aligneddc.com and connect with us on [Twitter](#), [LinkedIn](#) and [Facebook](#).